

HIGH PRESSURE FUEL PUMP REMOVAL/INSTALLATION[L3 Turbo]

id0114b4801400

Caution

- Do not disassemble the high pressure fuel pump.
- Do not scratch or damage the fuel sealing surface of the high and low fuel ports.
- When removing the high pressure fuel pipe, secure the joint (pump side) so that it does not rotate, and loosen the screw (pipe side).

Note

- If the high pressure fuel pump is removed, replace the O-ring with a new one.

1. Complete the "BEFORE SERVICE PRECAUTION". (See BEFORE SERVICE PRECAUTION[L3 Turbo].)
2. Disconnect the negative battery cable. (See BATTERY REMOVAL/INSTALLATION[L3 Turbo].)
3. Remove the charge air cooler cover. (See INTAKE AIR SYSTEM REMOVAL/INSTALLATION[L3 Turbo].)
4. Disconnect the spill valve control solenoid valve connector.
5. Disconnect the quick release connector on the high pressure fuel pump. (See QUICK RELEASE CONNECTOR REMOVAL/INSTALLATION[L3 Turbo].)
6. Remove the battery and battery tray. (See BATTERY REMOVAL/INSTALLATION[L3 Turbo].)
7. Remove the air duct. (See INTAKE AIR SYSTEM REMOVAL/INSTALLATION[L3 Turbo].)

Warning

- If the high pressure fuel pump joint nut is loosened, fuel leakage may occur resulting in death or serious injury, or damage to the equipment or the vehicle. Fuel can also irritate the skin and eyes. When removing the high pressure line pipe, always tighten the high pressure line pipe installation nut while fixing the high pressure fuel pump joint nut with a wrench. If the high pressure fuel pump joint nut has rotated, replace the high pressure fuel pump with a new one.

8. Disconnect the high pressure line pipe of the high pressure fuel pump.

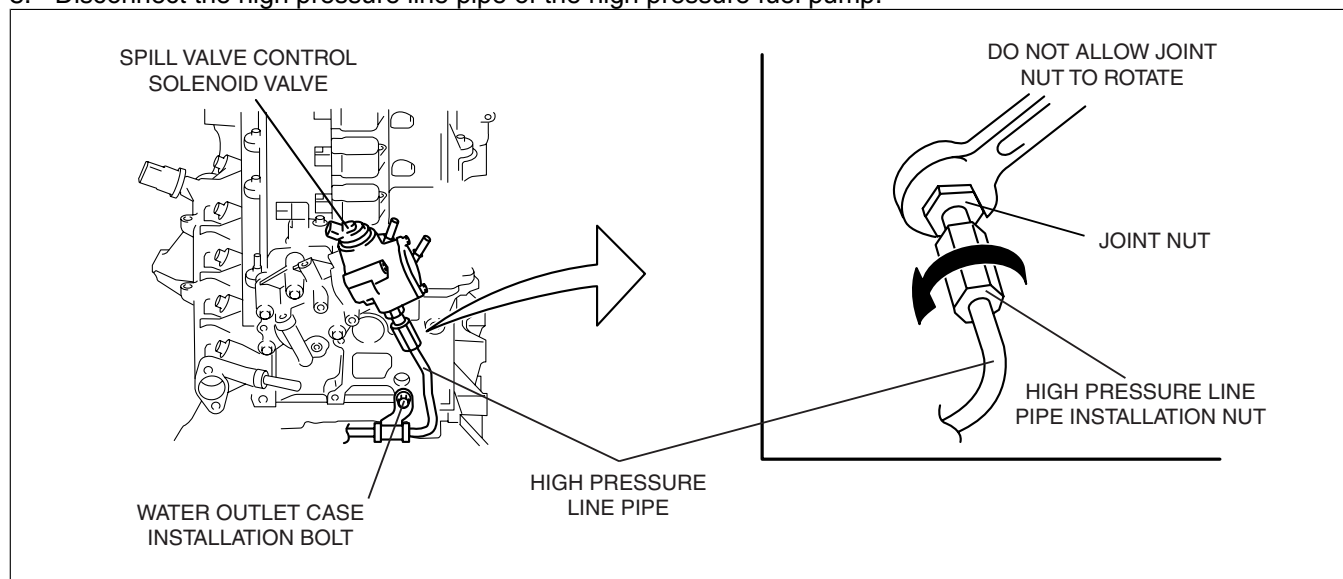

acxuuv00000291

- (1) Fix the joint nut with a wrench on the high pressure fuel pump side as shown in the figure.
 - (2) Loosen the high pressure line pipe installation nut.
9. Drain engine coolant. (See ENGINE COOLANT REPLACEMENT[L3 Turbo].)
 10. Loosen the water outlet case installation bolts securing the high pressure line pipe.

11. Remove the high pressure fuel pump.

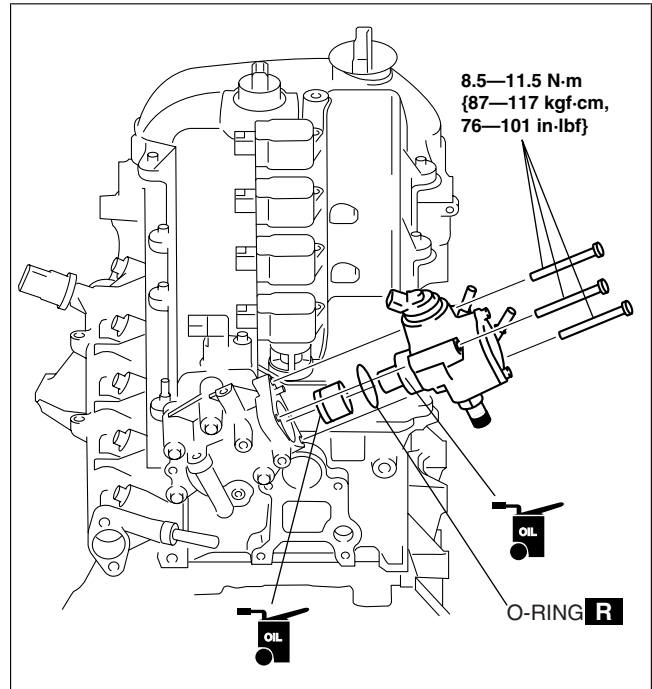

acxuuw00000292

12. Remove the high pressure fuel pump cover.

13. Tighten the bolts on the high pressure fuel pump cover.

Tightening torque

17—23 N·m {1.8—2.3 kgf·m, 13—16 ft·lbf}

Caution

- If the high pressure fuel pump installation bolts are tightened with the high pressure fuel pump tilted, the high pressure fuel pump may not operate correctly. Tighten the high pressure fuel pump installation bolts in a few passes with equal torque.

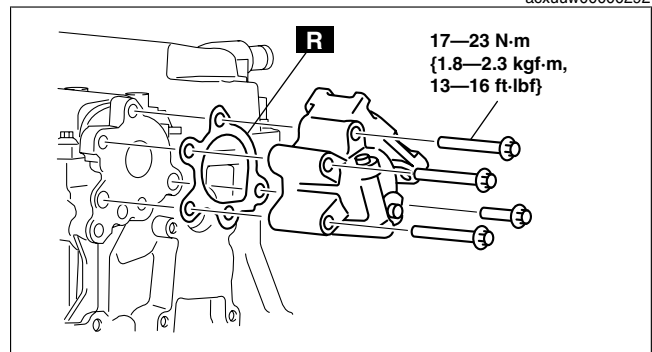

acxuuw00000293

14. Tighten the bolts on the high pressure fuel pump.

Tightening torque

8.5—11.5 N·m {87—117 kgf·cm, 76—101 in·lbf}

Warning

- If the high pressure fuel pump joint nut is loosened, fuel leakage may occur resulting in death or serious injury, or damage to the equipment or the vehicle. Fuel can also irritate the skin and eyes. When installing the high pressure line pipe, always tighten the high pressure line pipe installation nut while fixing the high pressure fuel pump joint nut with a wrench. If the high pressure fuel pump joint nut has rotated, replace the high pressure fuel pump with a new one.

15. Assemble the high pressure line pipe.

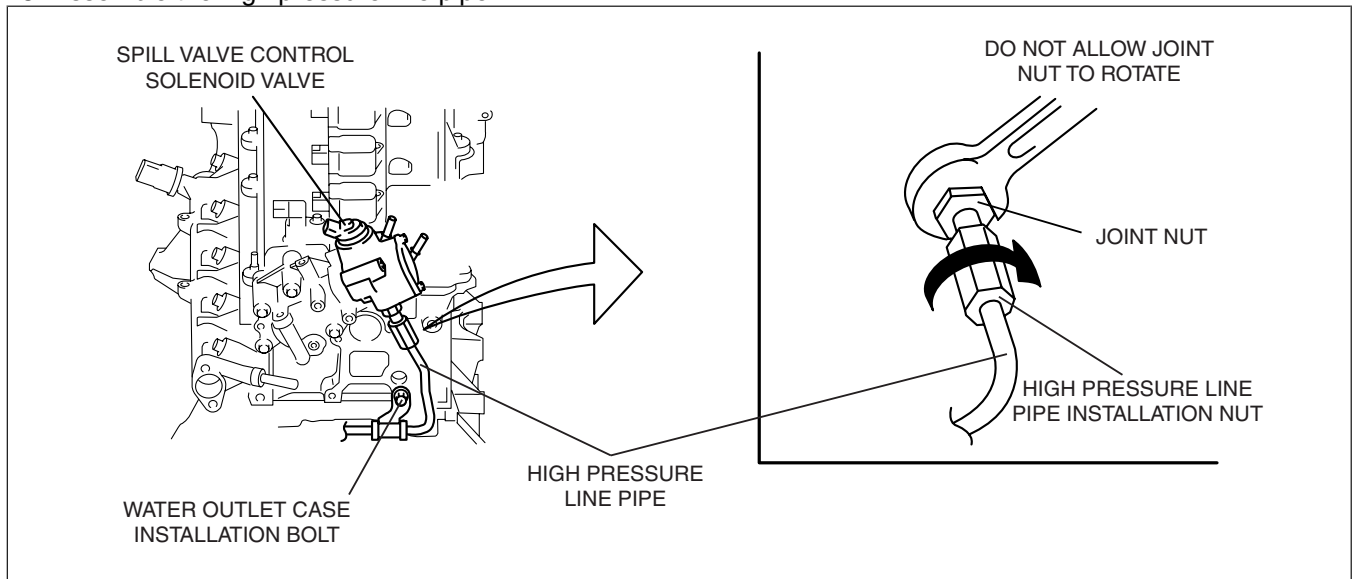

- (1) Fix the joint nut with a wrench on the high pressure fuel pump side as shown in the figure.
- (2) Tighten the high pressure line pipe installation nut.

Tightening torque

23.5—35.5 N·m {2.40—3.59 kgf·m, 17.4—26.0 ft·lbf}

16. Tighten the water outlet case installation bolts.

Tightening torque

8—11.5 N·m {82—117 kgf·cm, 71—101 in·lbf}

17. Install the quick release connector. (See QUICK RELEASE CONNECTOR REMOVAL/INSTALLATION[L3 Turbo].)

Fuel Leakage Inspection After High Pressure Fuel Pump Installation

1. Verify that the high pressure fuel pump is assembled securely.
2. Drive the vehicle starting from a standstill and brake suddenly **five to six times** at a low speed.
3. Stop the vehicle and verify from outside the vehicle that there is no fuel leakage around the high pressure fuel pump.