

FUEL PUMP UNIT DISASSEMBLY/ASSEMBLY[L3 Turbo]

id0114b4801000

Warning

- Fuel line spills and leakage are dangerous. Fuel can ignite and cause serious injuries or death and damage. Fuel can also irritate skin and eyes. To prevent this, do not damage the sealing surface of the fuel pump unit when removing or installing.

1. Disassemble in the order indicated in the table.
2. Assemble in the reverse order of disassembly.

1	Fuel filter body
2	Pressure regulator
3	Fuel pump
4	Fuel filter

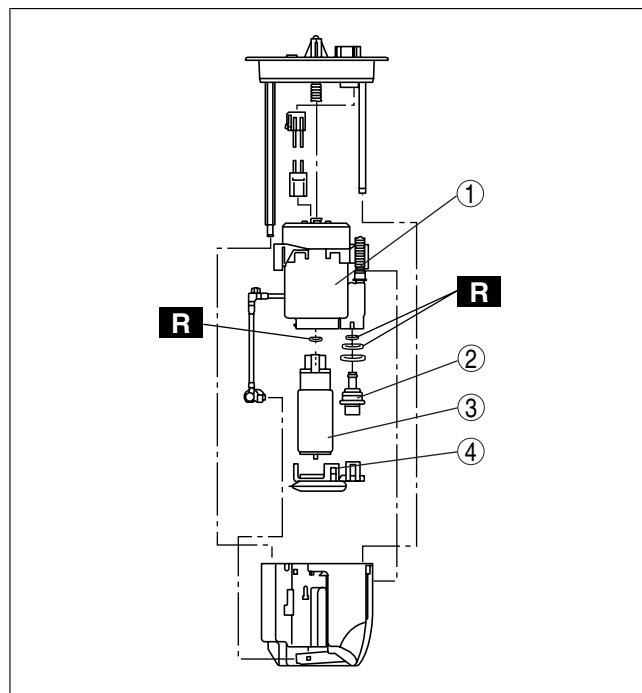

am3uuw00000291