

KNOCK SENSOR (KS) REMOVAL/INSTALLATION[L3 Turbo]

id0140b6802900

Caution

- Be careful not to impact the sensor.
- Verify that there is no debris between the sensor and the cylinder block before installing.

1. Disconnect the negative battery cable.
2. Remove the intake manifold. (See INTAKE AIR SYSTEM REMOVAL/INSTALLATION[L3 Turbo])
3. Remove the KS attachment bolt to remove the KS.
4. Install in the reverse order of removal.

Tightening torque

16—24 N·m {1.7—2.4 kgf·m, 12—17 ft·lbf}

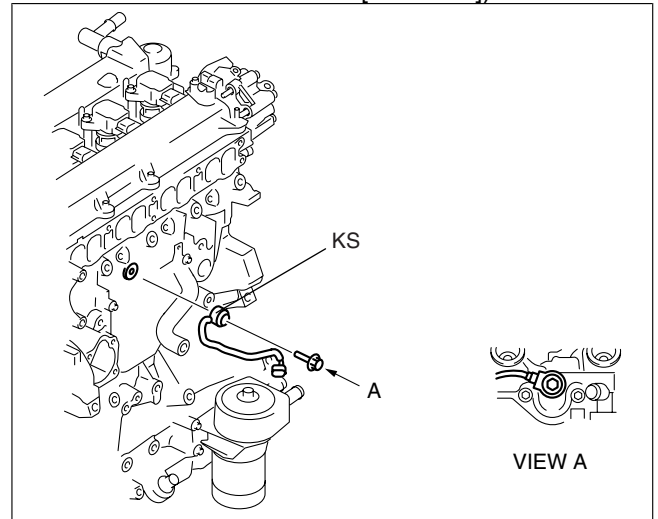

acxuuw00001859