

PCM REMOVAL/INSTALLATION[L3 Turbo]

id0140b6802400

Note

- For PCM replacement, set up the M-MDS and perform the PCM configuration. (See PCM CONFIGURATION[L3 Turbo].)

- Remove the battery cover.
- Disconnect the negative battery cable.
- Disconnect the PCM connector.
- When replacing the PCM on the vehicles, perform the following.
 - PCM parameter reset (See IMMOBILIZER SYSTEM COMPONENT REPLACEMENT/KEY ADDITION AND CLEARING[ADVANCED KEYLESS SYSTEM].) (See IMMOBILIZER SYSTEM COMPONENT REPLACEMENT/KEY ADDITION AND CLEARING[KEYLESS ENTRY SYSTEM].)
- Install in the reverse order of removal.

U.K. Specs.

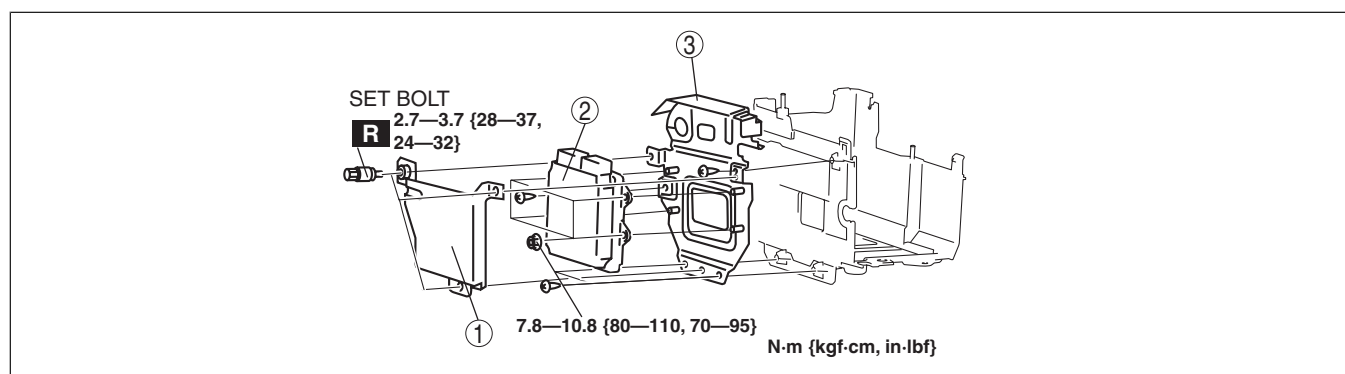

am3zzw00003701

1	PCM cover (See Set Bolt Removal Note .) (See Set Bolt Installation Note .)
---	--

2	PCM
3	PCM bracket

Except for U.K. Specs.

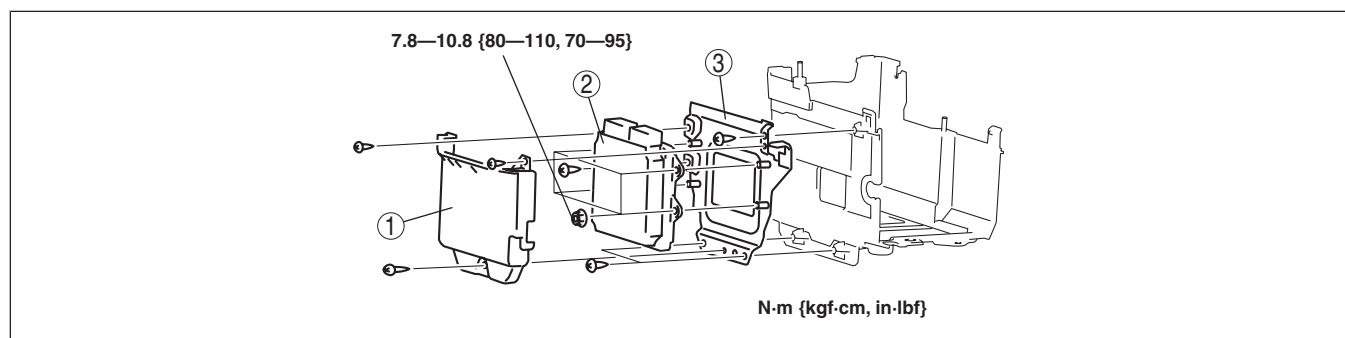

am3zzw00003702

1	PCM cover
---	-----------

2	PCM
3	PCM bracket

Set Bolt Removal Note

- Drill the set bolts using a drill bit with a diameter larger than the shanks until the heads are removed.
 - If the shanks are remained, remove them using locking pliers.
- Clean all foreign material from the PCM connectors.

Set Bolt Installation Note

- Install new set bolts and temporarily tighten them first, then tighten them until the necks of the bolts break off.