

REAR UPPER ARM REMOVAL/INSTALLATION

id021400800800

1. Remove the rear auto leveling sensor. (See AUTO LEVELING SENSOR REMOVAL/INSTALLATION.)
2. Remove in the order indicated in the table.
3. Install in the reverse order of removal.
4. Inspect the wheel alignment and adjust it if necessary. (See REAR WHEEL ALIGNMENT.)

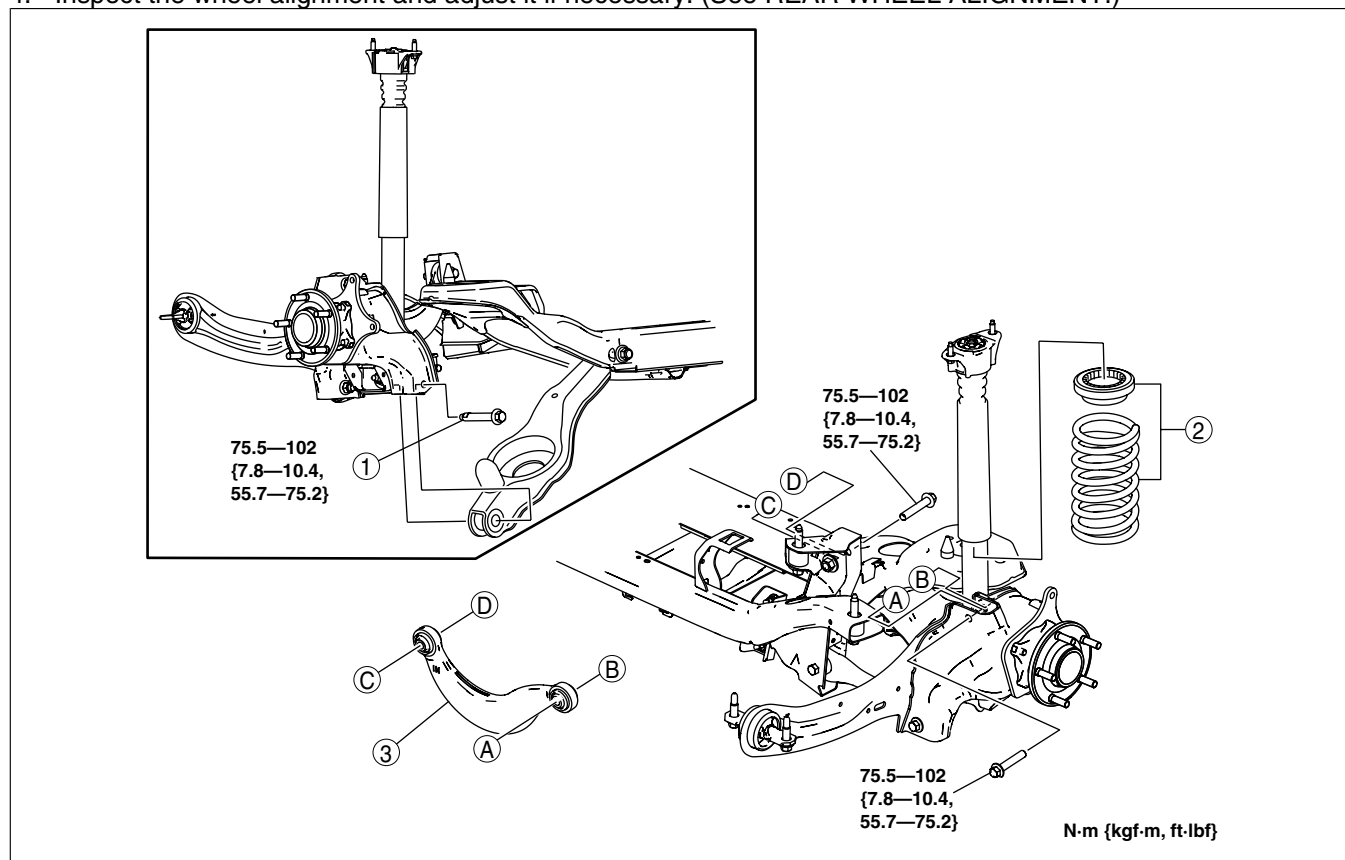

1	Rear lower arm outer bolt (See Rear Lower Arm Outer Bolt Removal Note .)
---	---

2	Rear coil spring component (See REAR COIL SPRING REMOVAL/INSTALLATION.)
3	Rear upper arm (See Rear Upper Arm Installation Note .)

Rear Lower Arm Outer Bolt Removal Note

1. Support the rear lower arm using a jack.
2. Loosen the rear lower arm inner bolt.
3. Remove the rear lower arm outer bolt.

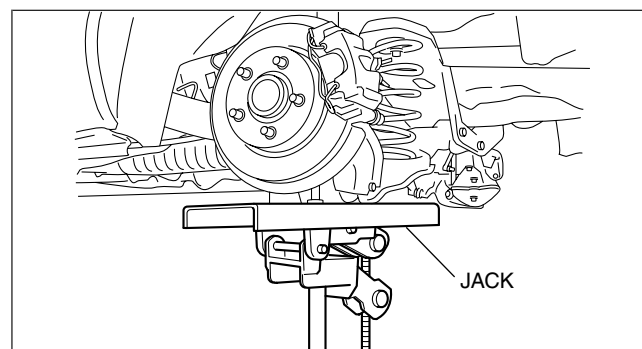

am3zzw00002853

Rear Upper Arm Installation Note

1. Install the rear upper arm so that IN mark is facing toward the inside of the vehicle.

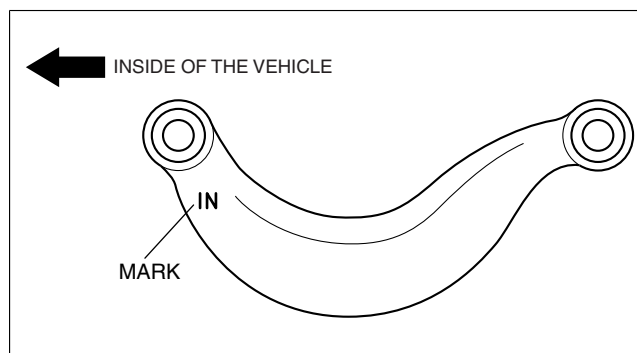

am3zzw00002854